

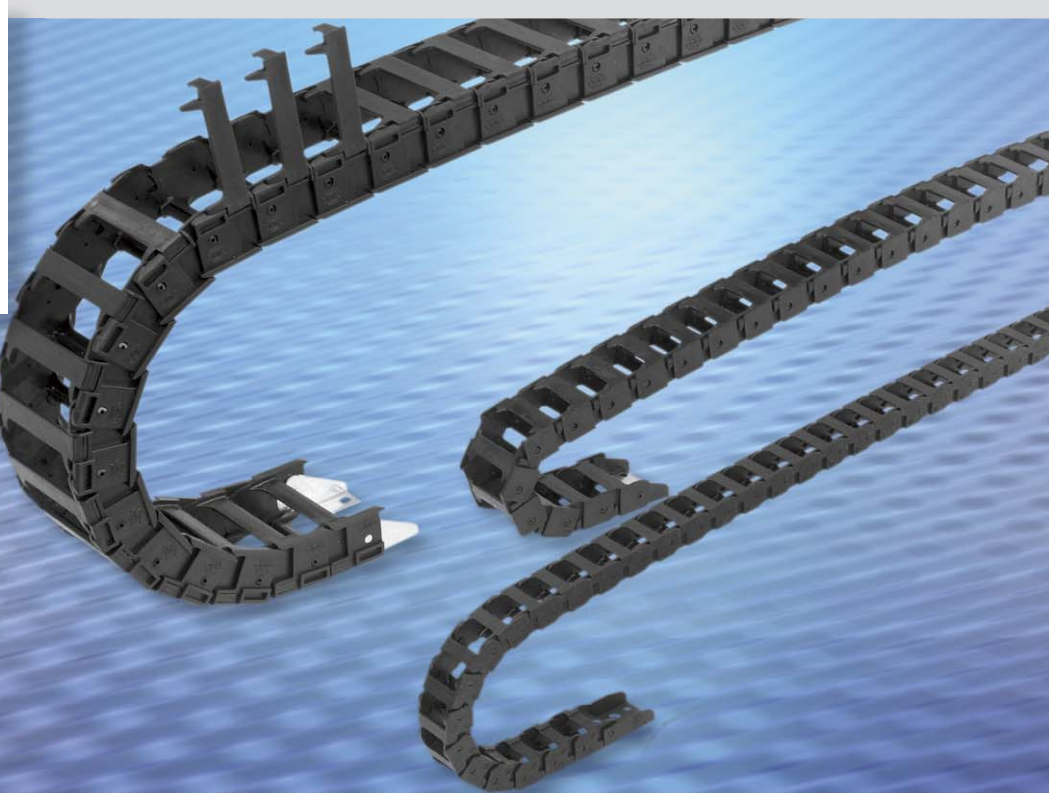

PLASTITRAK

plastic
carrier
plastic cable carrier system
cable system

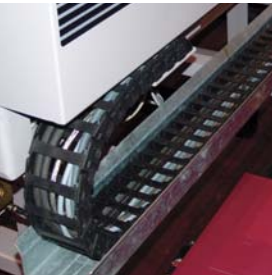

KABELSCHLEPP

Key Features:

- Light weight and rugged links molded from fiber-reinforced nylon material
- Available in a wide range of fixed widths
- Easy to snap-together links make assembly and modifications to chain length effortless
- Vertical and horizontal cable separation in nylon or aluminum available
- Links are available with optional hinged-opening cavity lids for quick and simple installation of cables and hoses
- End brackets with integrated strain relief optional on most sizes
- The lowest priced and therefore most economical product group to apply
- Most sizes are available immediately from stock throughout the world



GENERAL DATA

E	CONOMIC
V	ALUE
A	DDDED
3	
<p>A product group's EVA score is a general indicator that allows a customer to quickly and easily compare a product group's basic price, features, capabilities and value relative to other comparably sized products within the KS product range.</p>	
<p>Download 3D CAD files, videos, updated product info & much more at: www.kabelschlepp.com/plastitrak.htm</p>	

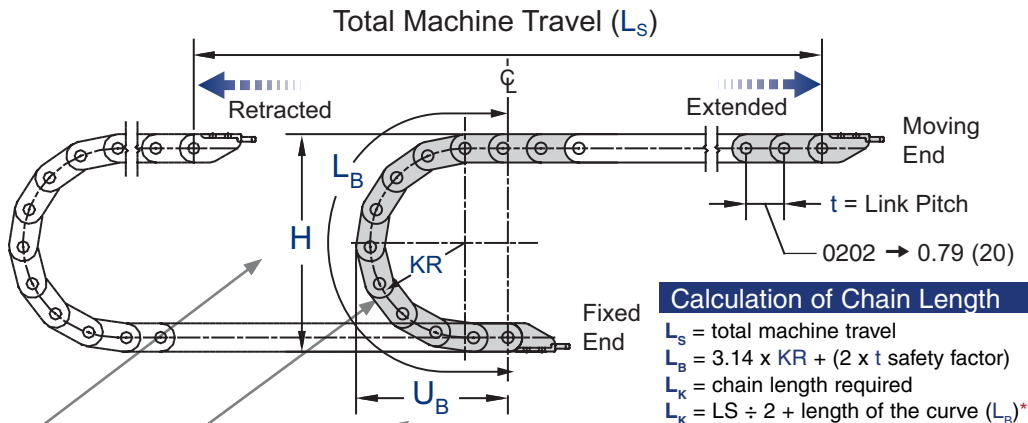

Calculation of Chain Length

- L_s = total machine travel
 - $L_B = 3.14 \times KR + (2 \times t \text{ safety factor})$
 - L_K = chain length required
 - $L_K = L_s \div 2 + \text{length of the curve } (L_B)^*$
- * Assumes the Fixed Point is located at the Center of the Total Machine Travel.

Dimensions in inches (mm)

Technical Data

Series
0202

	Mounting Height H	Bend Radius KR	Depot U_B	Loop Length L_B
Option A	2.01 (51)	0.71 (18)	1.77 (45)	3.82 (97)
Option B	2.80 (71)	1.10 (28)	2.17 (55)	5.04 (128)
Option C	3.58 (91)	1.50 (38)	2.56 (65)	6.30 (160)
Option D	4.53 (115)	1.97 (50)	3.03 (77)	7.76 (197)



Self-Supporting Lengths

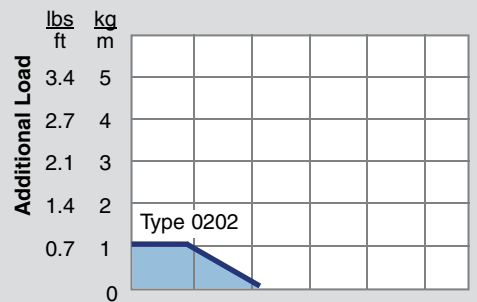

Unsupported Length 1.64 3.28 4.92 6.56 8.2 ft
0.5 1.0 1.5 2.0 2.5 m

Extended Travel:

When application travel exceeds the self-supporting length of the carrier, PLASTITRAK carrier systems are designed to glide on themselves in a guide channel.



For more information on extended travel systems, see pages 2.27-2.36



Number of **Systems Req.** x Carrier **Type** + Cavity Width **(B_i)** + Bend **Radius** x # of Links **Length** + Type & Position **Brackets** + Dividers **(#vert / #horz)**

↓ ↓ ↓ ↓ ↓ ↓ ↓ ↓

5 x **0202** + **15** **KR** **28** x **36** **Links** + **FA/MI** + not available for **0202**

Specifications are subject to change without notice.
KS-1106-GC-A

Non-Opening Links - available widths

0202.06

Chain Weight:
0.09 lbs/ft
(0.14 kg/m)

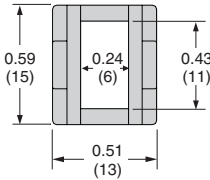

0202.10

Chain Weight:
0.10 lbs/ft
(0.15 kg/m)

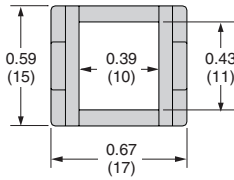

0202.15

Chain Weight:
0.11 lbs/ft
(0.16 kg/m)

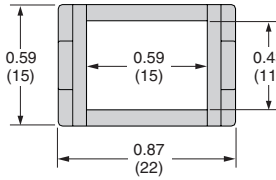

0202.20

Chain Weight:
0.11 lbs/ft
(0.17 kg/m)

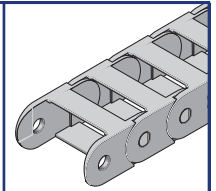
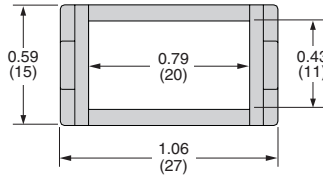

links do not open

Series

0202 Strain Relief Mounting Brackets

Fixed End Brackets - with pin

0202.06

PN: 53390

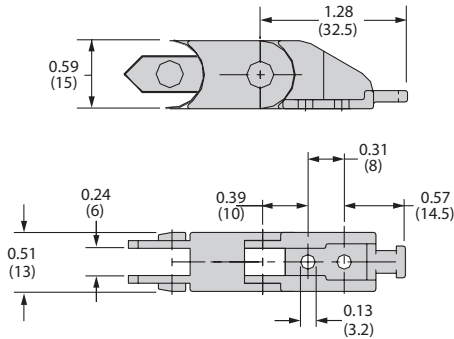

0202.10

PN: 53392

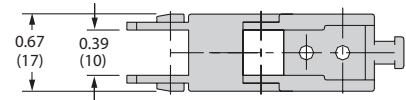

0202.15

PN: 53394

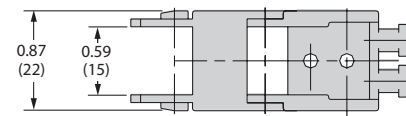

0202.20

PN: 53396

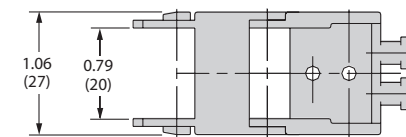

Moving End Brackets - with hole

0202.06

PN: 53391

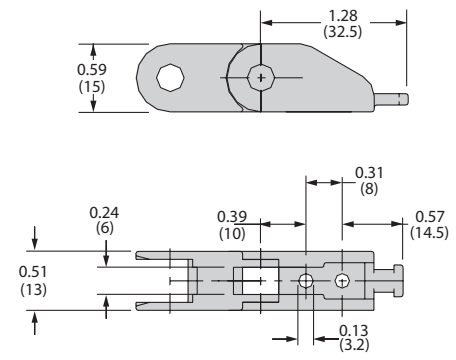

0202.10

PN: 53393

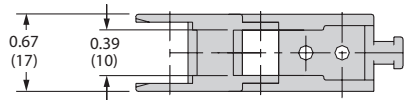

0202.15

PN: 53395

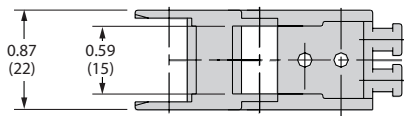

0202.20

PN: 53397

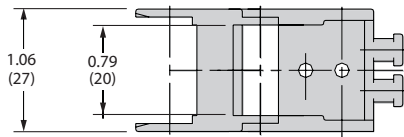

Fixed End Bracket

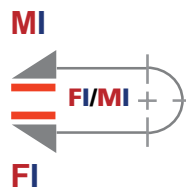
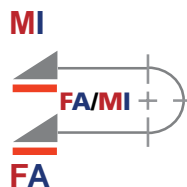
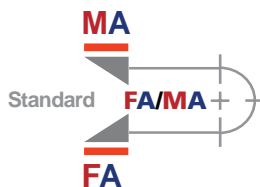

- M** = Moving End
- F** = Fixed End
- A** = O.D. Mount
- I** = I.D. Mount
- = Mounting Surface

Moving End Bracket



Specifications are subject to change without notice.
KS-1106-GC-A



GENERAL DATA

E	CONOMIC
V	ALUE
A	DEED
3	
<p>A product group's EVA score is a general indicator that allows a customer to quickly and easily compare a product group's basic price, features, capabilities and value relative to other comparably sized products within the KS product range.</p>	
<p>Download 3D CAD files, videos, updated product info & much more at: www.kabelschlepp.com/plastitrak.htm</p>	

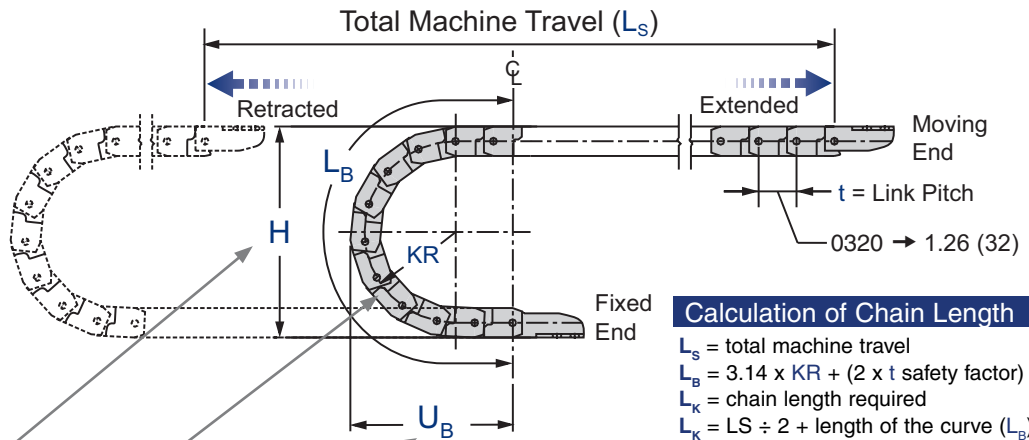

Calculation of Chain Length

- L_s = total machine travel
 - L_b = $3.14 \times KR + (2 \times t \text{ safety factor})$
 - L_k = chain length required
 - $L_k = L_s \div 2 + \text{length of the curve } (L_b)^*$
- * Assumes the Fixed Point is located at the Center of the Total Machine Travel.

Dimensions in inches (mm)

Technical Data

Series	Mounting Height H	Bend Radius KR	Depot U_B	Loop Length L_B
Option A	3.90 (99)	1.46 (37)	3.23 (82)	7.13 (181)
Option B	4.69 (119)	1.85 (47)	3.62 (92)	8.35 (212)
Option C	7.05 (179)	3.03 (77)	4.80 (122)	12.05 (306)
Option D [*] <i>special order</i>	8.86 (225)	3.94 (100)	5.71 (145)	14.92 (379)

! * Bend Radius (KR) 100 is available via **special order**. Consult factory for details.

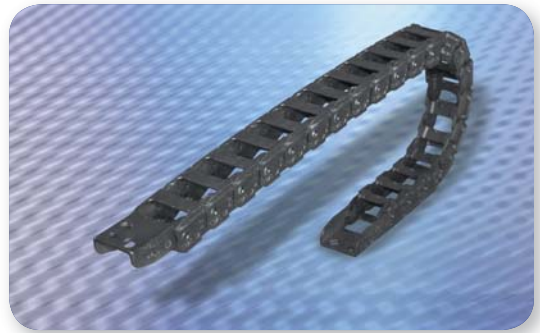

Self-Supporting Lengths

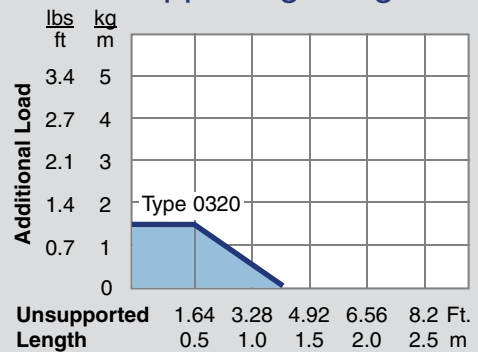

Extended Travel:

When application travel exceeds the self-supporting length of the carrier, PLASTITRAK carrier systems are designed to glide on themselves in a guide channel.



For more information on extended travel systems, see pages 2.27-2.36



major credit cards accepted

Number of **Systems Req.** x Carrier **Type** + Frame Stay **Width** + Bend **Radius** x # of Links **Length** + Type & Position **Brackets** + Dividers **(#vert / #horz)**

10 x **0320** + **41** **KR** **77** x **62 Links** + **FA/MA** + not available for **0320**

Specifications are subject to change without notice. KS-1106-GC-A

Series **0320**
Non-Opening Link - available widths

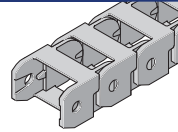

0320.20

Chain Weight:
0.21 lbs/ft
(0.32 kg/m)

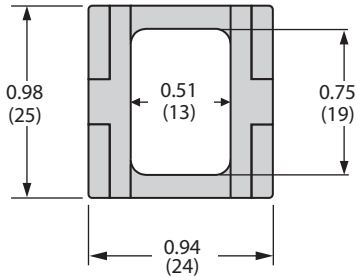

0320.30

Chain Weight:
0.23 lbs/ft
(0.35 kg/m)

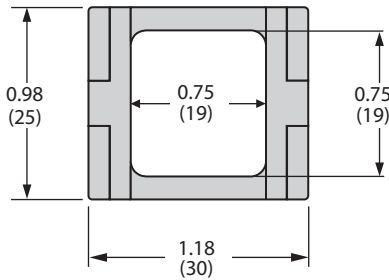

0320.42

Chain Weight:
0.26 lbs/ft
(0.39 kg/m)

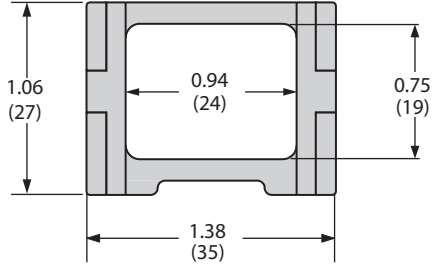

0320.52

Chain Weight:
0.30 lbs/ft
(0.44 kg/m)

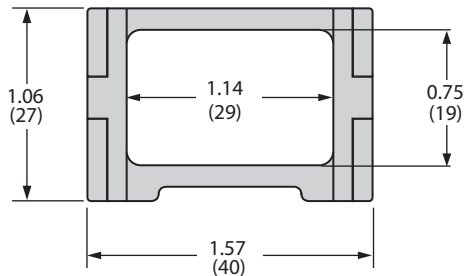

0320.62

Chain Weight:
0.32 lbs/ft
(0.47 kg/m)

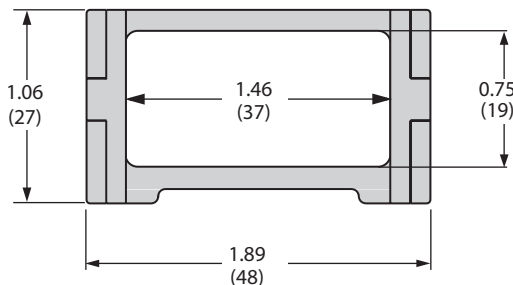

Series **0320**
Openable Link - with pull out cover strip

0320.41*

Chain Weight:
0.26 lbs/ft
(0.38 kg/m)

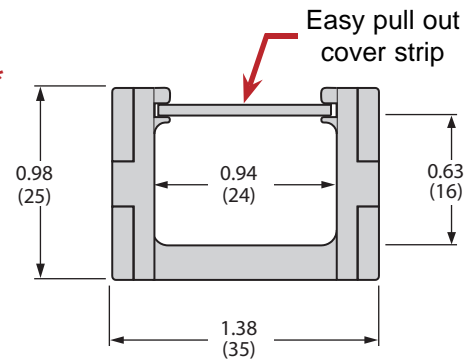

* Available with 1.46" (37 mm) or 3.03" (77 mm) bend radius (KR)

Series **0320**
Non-Opening Link - with fixed dividers

0320.64

Chain Weight:
0.33 lbs/ft
(0.49 kg/m)

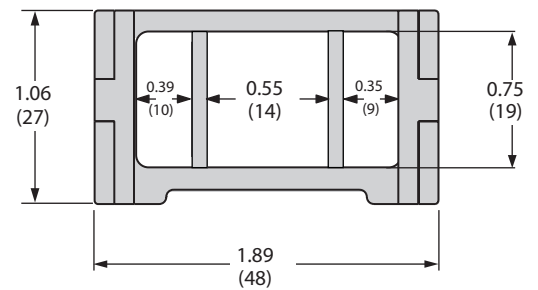

Note:

For drawings and dimensions of available Mounting Bracket options see pages 6.6 - 6.7.

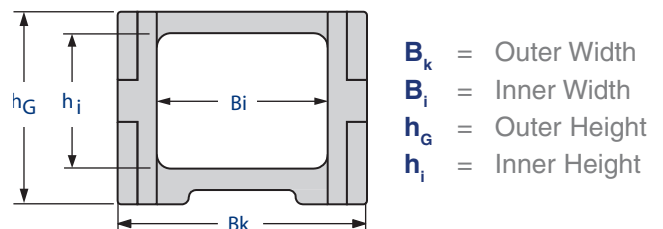



Series 0320 Standard Mounting Brackets (without strain relief)

Standard Nylon Mounting Brackets for Plastitrak 0320 Series

6 PLASTITRAK

Fixed End Bracket - with pin

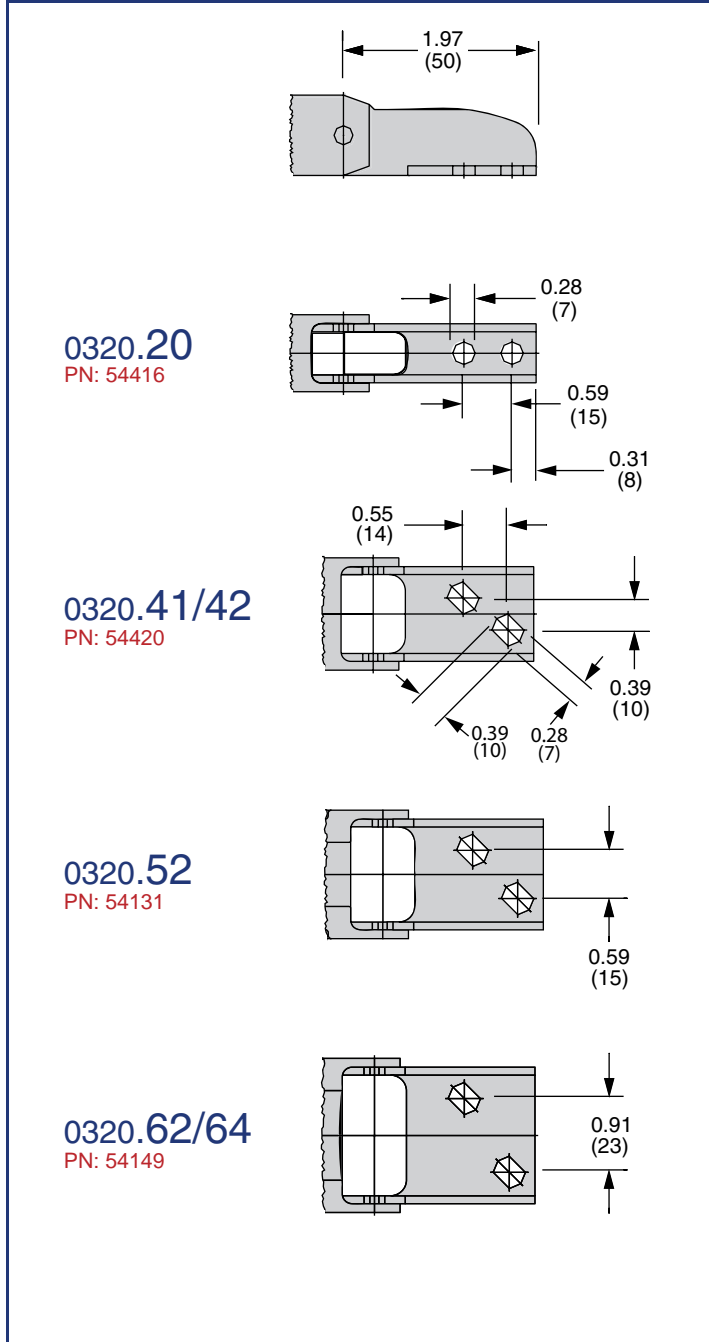

Moving End Bracket - with hole

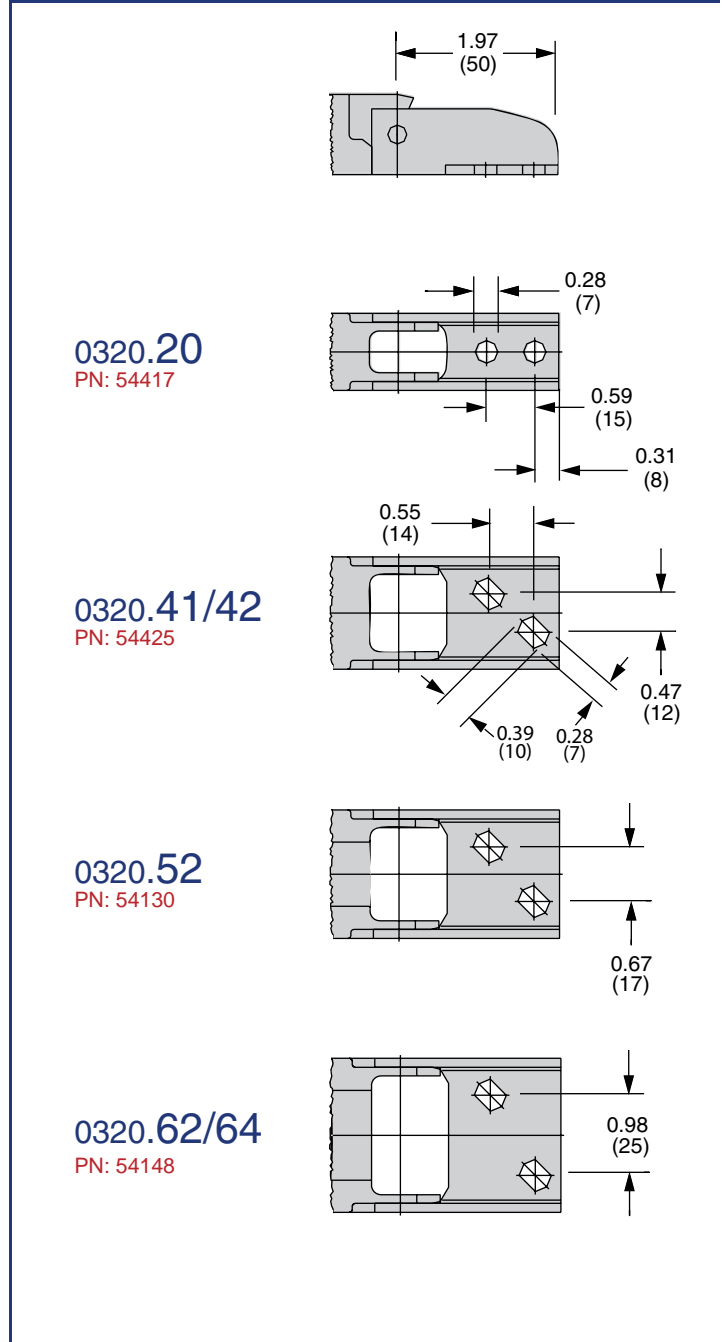

Fixed End Bracket

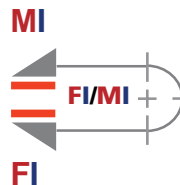

- M** = Moving End
- F** = Fixed End
- A** = O.D. Mount
- I** = I.D. Mount
- = Mounting Surface

Moving End Bracket



Specifications are subject to change without notice.
KS-1106-GC-A

Series 0320 Strain Relief Mounting Brackets

Integral Strain Relief Nylon Mounting Brackets for Plastitrak 0320 Series

Fixed End Bracket - with pin

0320.20
PN: 52319

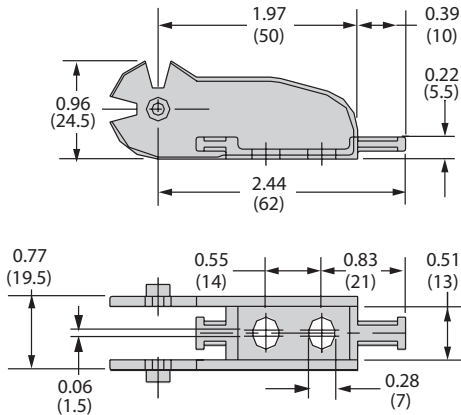

0320.30
PN: 52321

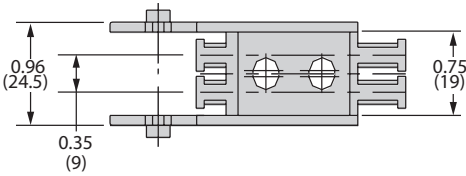

0320.41/42
PN: 52323

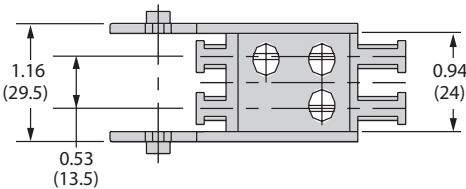

0320.52
PN: 52325

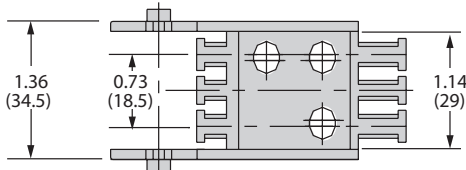

0320.62/64
PN: 52327

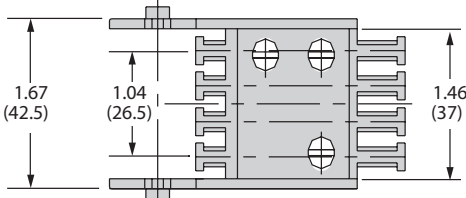

Moving End Bracket - with hole

0320.20
PN: 52318

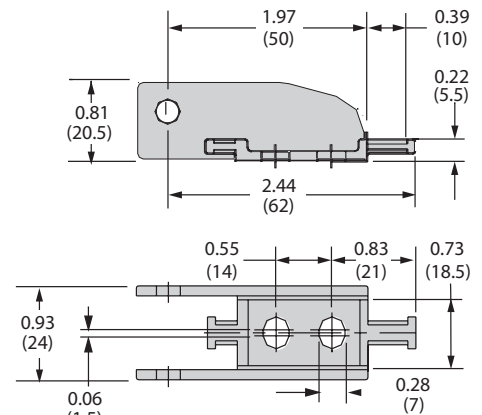

0320.30
PN: 52320

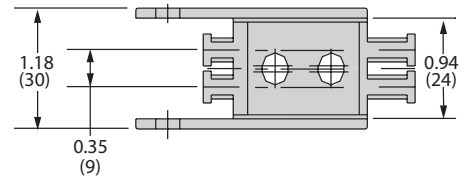

0320.41/42
PN: 52322

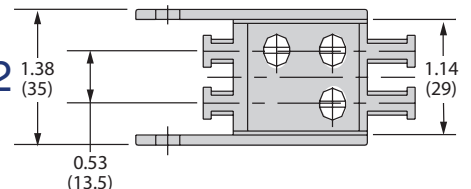

0320.52
PN: 52324

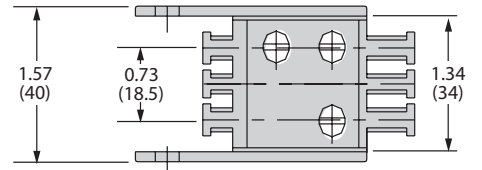

0320.62/64
PN: 52326

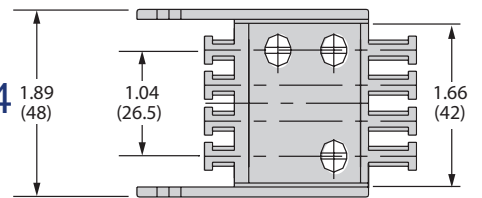

Fixed End Bracket

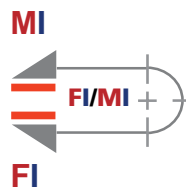

- M** = Moving End
- F** = Fixed End
- A** = O.D. Mount
- I** = I.D. Mount
- = Mounting Surface

Moving End Bracket



Specifications are subject to change without notice.
KS-1106-GC-A

GENERAL DATA

E	CONOMIC
V	ALUE
A	DDED
3	
<p>A product group's EVA score is a general indicator that allows a customer to quickly and easily compare a product group's basic price, features, capabilities and value relative to other comparably sized products within the KS product range.</p>	
<p>Download 3D CAD files, videos, updated product info & much more at: www.kabelschlepp.com/plastitrak.htm</p>	

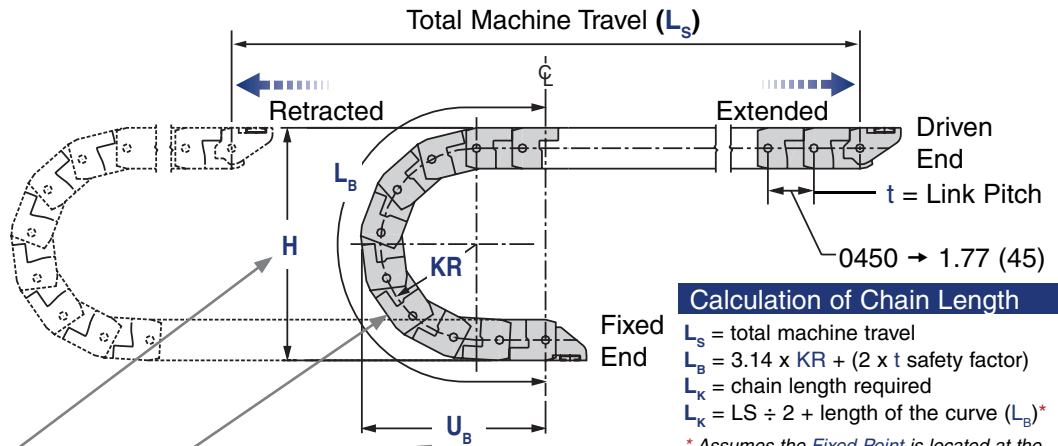

Calculation of Chain Length

L_s = total machine travel
 L_b = $3.14 \times KR + (2 \times t \text{ safety factor})$
 L_k = chain length required
 $L_k = L_s \div 2 + \text{length of the curve } (L_b)^*$

* Assumes the Fixed Point is located at the Center of the Total Machine Travel.

Dimensions in inches (mm)

Technical Data

Series	Mounting Height H	Bend Radius KR	Depot U_B	Loop Length L_B
0450				
Non-Opening Links				
Option A non-opening	5.43 (138)	2.05 (52)	4.49 (114)	10.00 (254)
Option B non-opening	8.74 (222)	3.70 (94)	6.14 (156)	15.20 (386)
Option C non-opening	11.18 (284)	4.92 (125)	7.36 (187)	19.02 (483)
Option D non-opening	13.15 (334)	5.91 (150)	8.35 (212)	22.13 (562)
Snap-Open Links				
Option E snap-open	5.67 (144)	2.05 (52)	4.61 (117)	10.00 (254)
Option F snap-open	8.98 (228)	3.70 (94)	6.26 (159)	15.20 (386)
Option G snap-open	11.42 (290)	4.92 (125)	7.48 (190)	19.02 (483)
Option H snap-open	13.39 (340)	5.91 (150)	8.46 (215)	22.13 (562)
Option I * snap-open	17.32 (440)	7.87 (200)	10.43 (265)	28.31 (719)



Self-Supporting Lengths

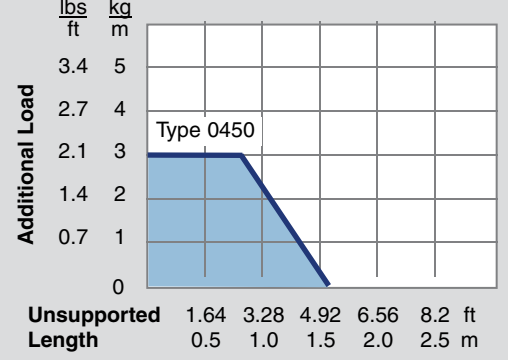

Extended Travel:
 When application travel exceeds the self-supporting length of the carrier, PLASTITRAK carrier systems are designed to glide on themselves in a guide channel.



For more information on extended travel systems, see pages 2.27-2.36

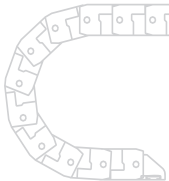

major credit cards accepted

Number of **Systems Req.** x Carrier **Type** + Frame Stay **Width** + Bend **Radius** x # of Links **Length** + Type & Position **Brackets** + Dividers **(#vert / #horz)**
 $15 \times 0450 + 60 \text{ KR } 125 \times 82 \text{ Links} + \text{FA/MA} + 3v/0h$

Specifications are subject to change without notice. KS-1106-GC-A

Series 0450
Non-Opening Link - available widths

0450.20

Chain Weight:
0.44 lbs/ft
(0.65 kg/m)

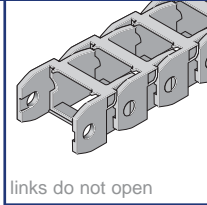
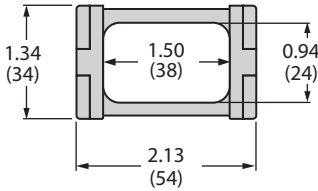

0450.22

Chain Weight:
0.50 lbs/ft
(0.75 kg/m)

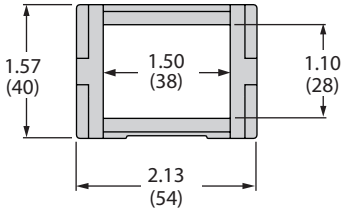

0450.40

Chain Weight:
0.52 lbs/ft
(0.78 kg/m)

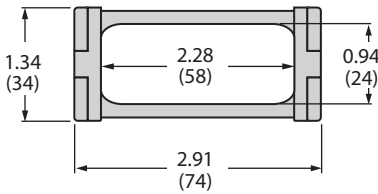

0450.60

Chain Weight:
0.62 lbs/ft
(0.92 kg/m)



0450.85

Chain Weight:
0.80 lbs/ft
(1.20 kg/m)

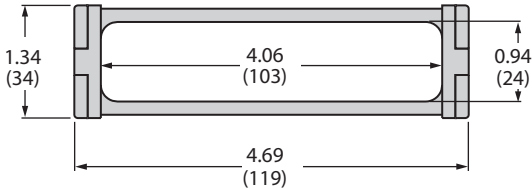

Optional Dividers

for Non-Opening links
(.10,.20,.40,.60 widths)

Divider
position is
adjustable

PN: 56725

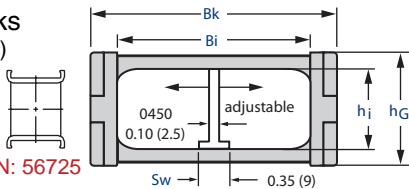

Series 0450
Snap-Open Link - available widths

0450.21

Chain Weight:
0.40 lbs/ft
(0.75 kg/m)

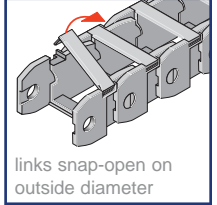
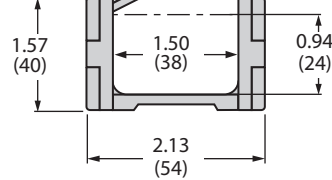

0450.41

Chain Weight:
0.57 lbs/ft
(0.85 kg/m)

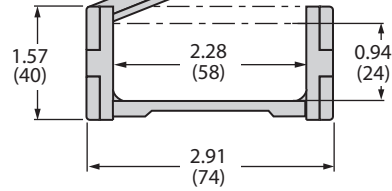

0450.61

Chain Weight:
0.62 lbs/ft
(0.92 kg/m)

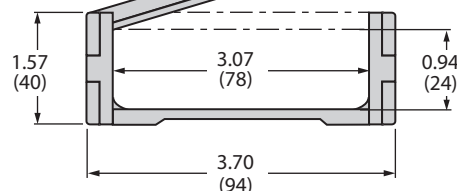

0450.81

Chain Weight:
0.80 lbs/ft
(1.20 kg/m)

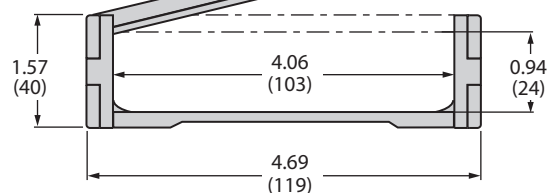

Optional Dividers

for Snap-Open links

Divider
position is
adjustable

PN: 56720

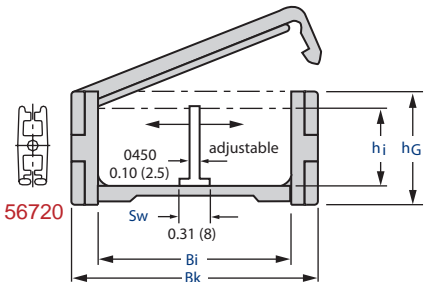

Note:

For drawings and dimensions of
available Mounting Bracket options
see pages 6.10 - 6.13.





Series

0450 Standard Mounting Brackets (without strain relief)

Standard 4 Piece Metal Mounting Brackets for **Non-Opening** Style Links (.10/.20/.40/.60/.85)

Fixed End Bracket - with pin

Note: brackets can be positioned with feet facing inward (standard) or outward

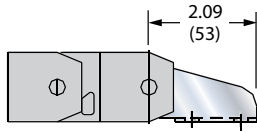

Fixed End Bracket consists of 2 pcs

0450.20

PNs: 55708
55709

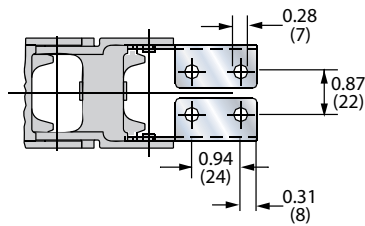

0450.40

PNs: 55708
55709

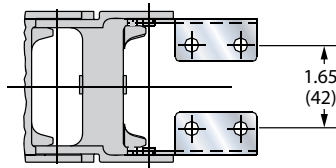

0450.60

PNs: 55708
55709

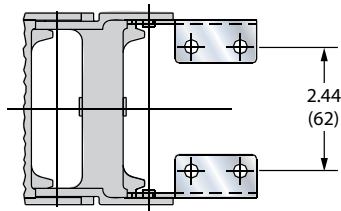

0450.85

PNs: 55708
55709

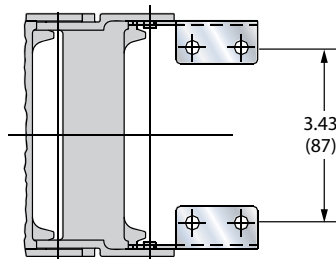

Moving End Bracket - with hole

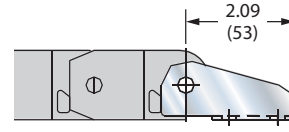

Moving End Bracket consists of 2 pcs

0450.20

PNs: 55706
55707

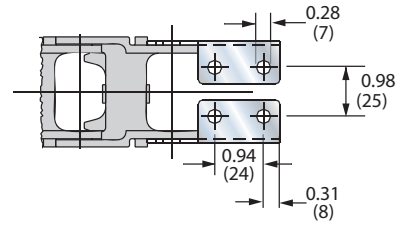

0450.40

PNs: 55706
55707

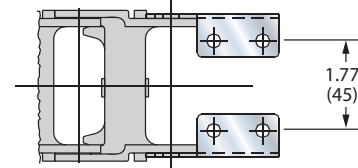

0450.60

PNs: 55706
55707

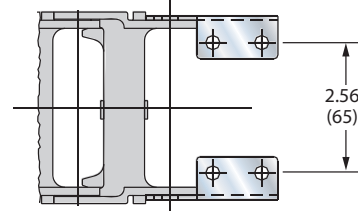

0450.85

PNs: 55706
55707

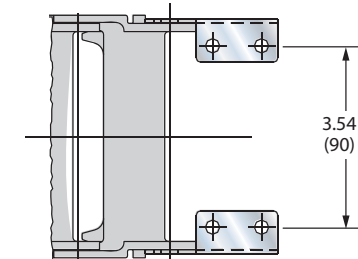

Fixed End Bracket



Moving End Bracket



M = Moving End
F = Fixed End
A = O.D. Mount
I = I.D. Mount
— = Mounting Surface

Specifications are subject to change without notice.
KS-1106-GC-A

Series

0450 Standard Mounting Brackets (without strain relief)

Standard Nylon/Metal Mounting Brackets for **Snap-Open** Style Links (.21/.22/.41/.61/.81)

Fixed End Bracket - with pin

0450.21/22
PN: 57900

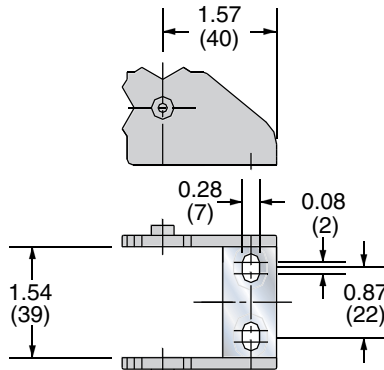

0450.41
PN: 57969

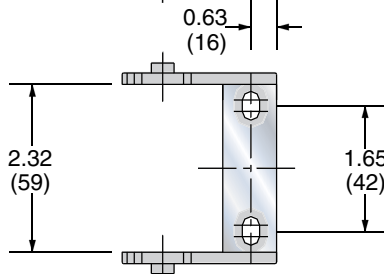

0450.61
PN: 57994

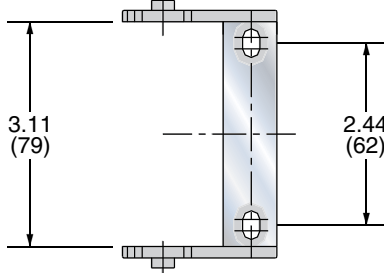

0450.81
PN: 58131

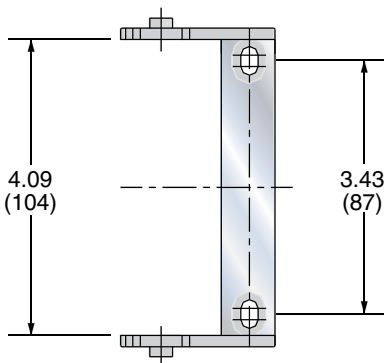

Moving End Bracket - with hole

0450.21/22
PN: 57890

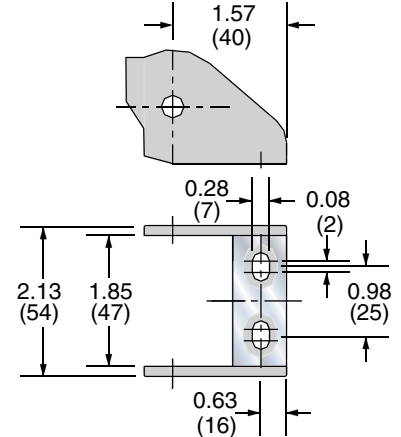

0450.41
PN: 57968

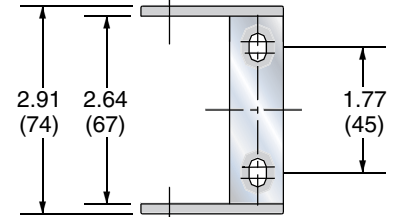

0450.61
PN: 57993

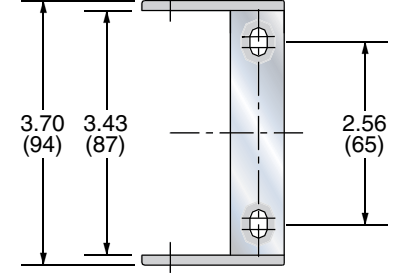

0450.81
PN: 58130

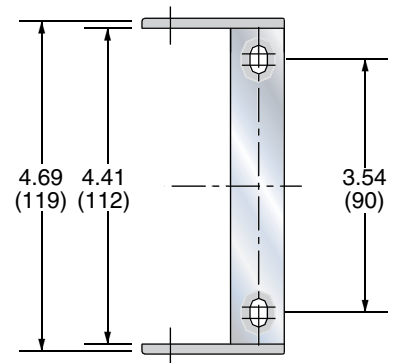

Fixed End Bracket

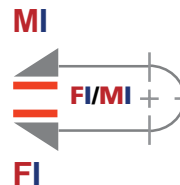

- M** = Moving End
- F** = Fixed End
- A** = O.D. Mount
- I** = I.D. Mount
- = Mounting Surface

Moving End Bracket



Specifications are subject to change without notice.
KS-1106-GC-A



Series

0450 Strain Relief Mounting Brackets

Integral Strain Relief Nylon Mounting Brackets for **Non-Opening** Style Links (.20/.40/.60/.85)

Fixed End Bracket - with pin

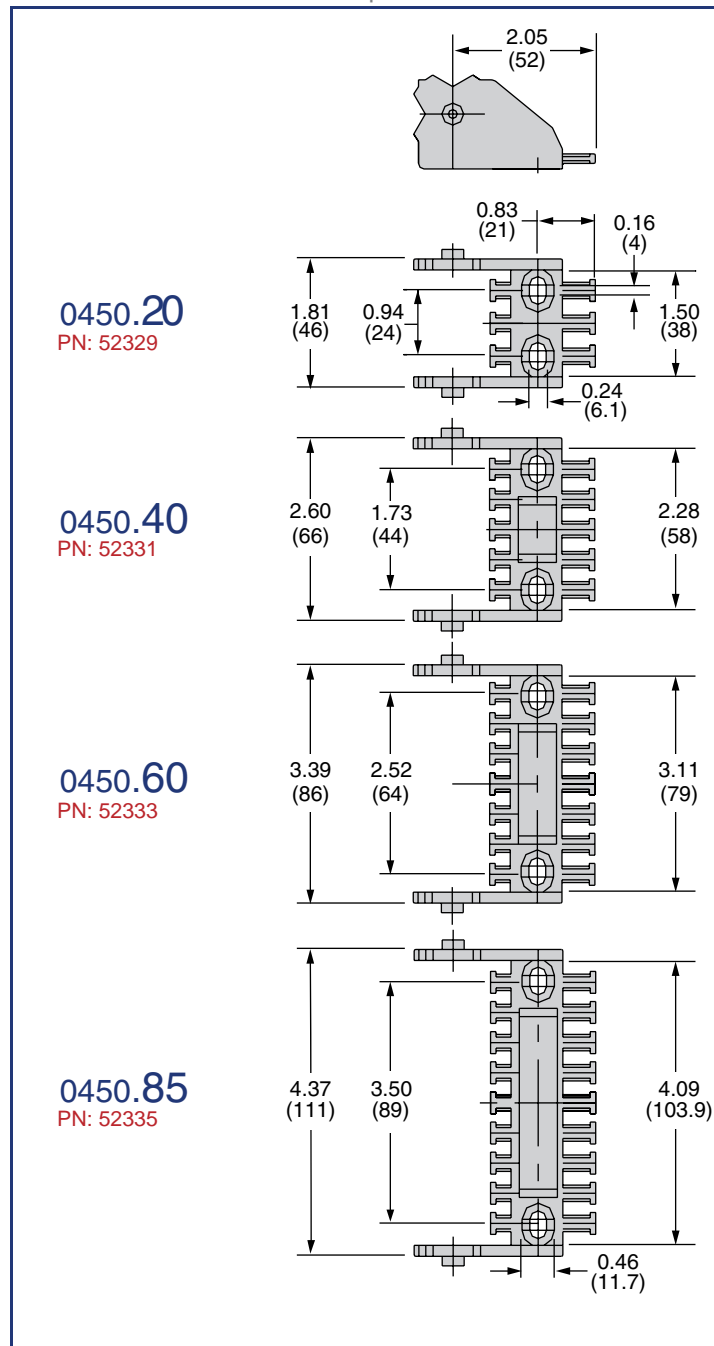

Moving End Bracket - with hole

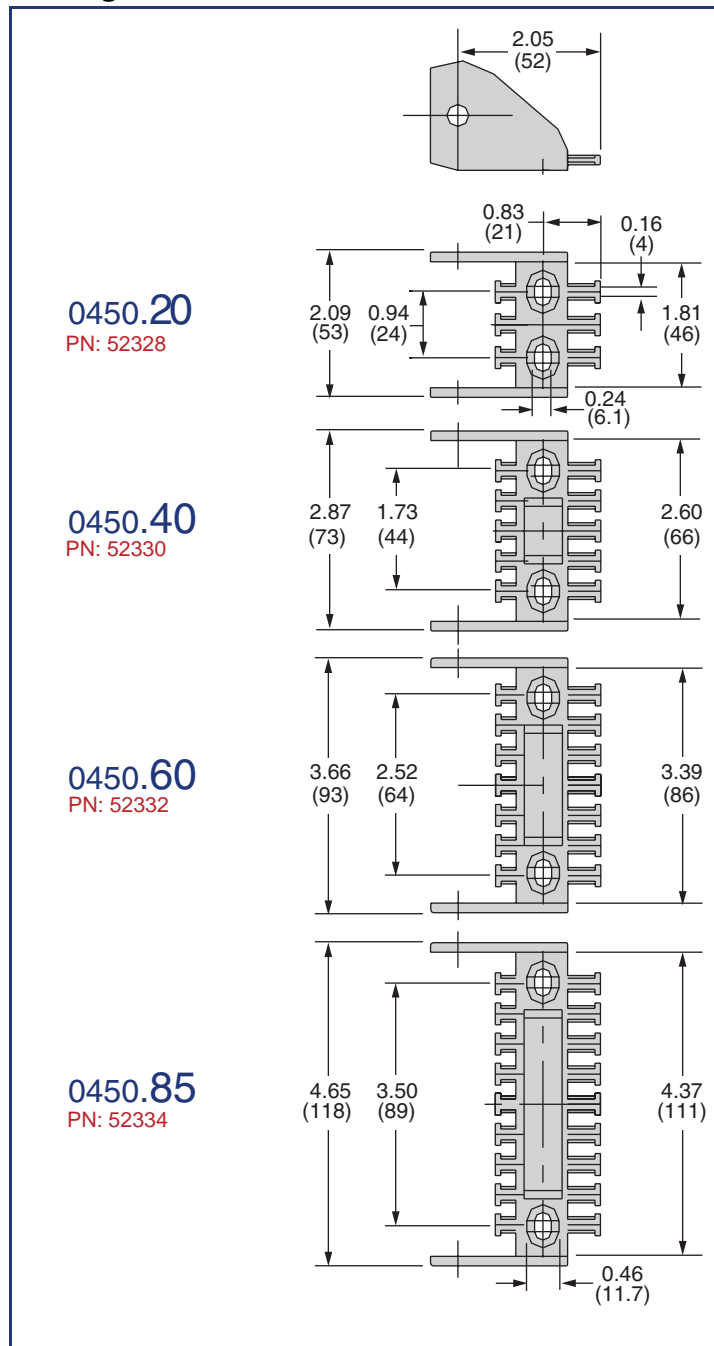

6 PLASTITRAK

Fixed End Bracket

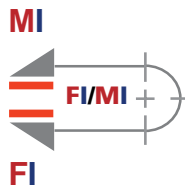

- M** = Moving End
- F** = Fixed End
- A** = O.D. Mount
- I** = I.D. Mount
- = Mounting Surface

Moving End Bracket



Specifications are subject to change without notice. KS-1106-GC-A

Series
0450 Strain Relief Mounting Brackets

Integral Strain Relief Nylon Mounting Brackets for **Snap-Open** Style Links (.21/.22/.41/.61/.81)

Fixed End Bracket - with pin

Moving End Bracket - with hole

0450.21
PN: 52337

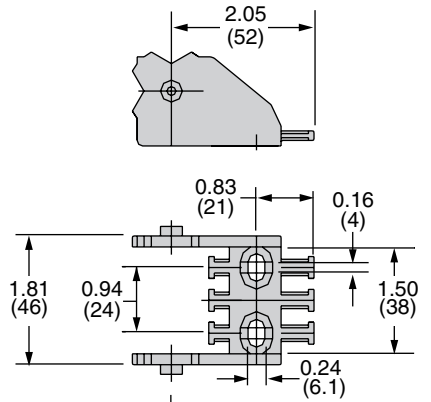

0450.41
PN: 52339

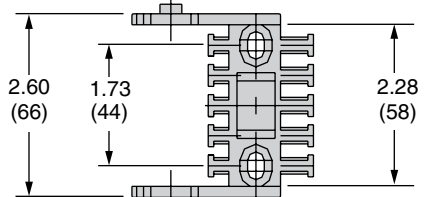

0450.61
PN: 52341

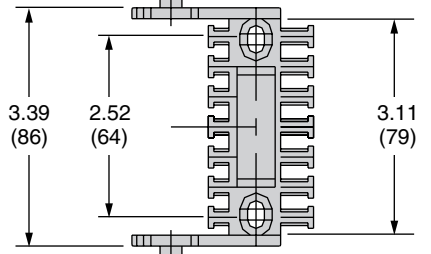

0450.81
PN: 52343

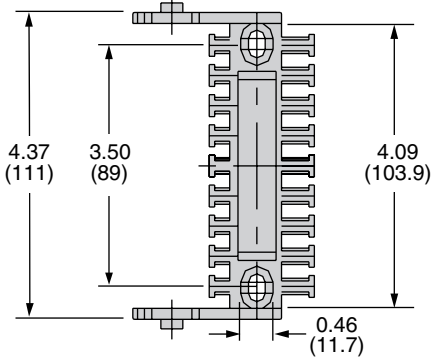

0450.21
PN: 52336

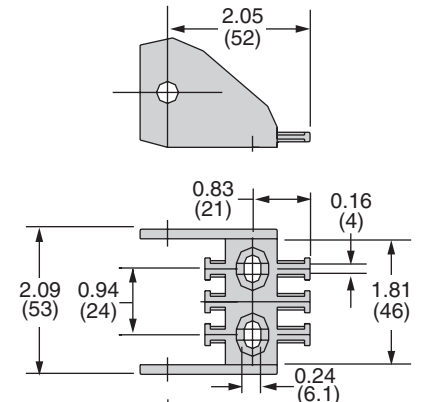

0450.41
PN: 52338

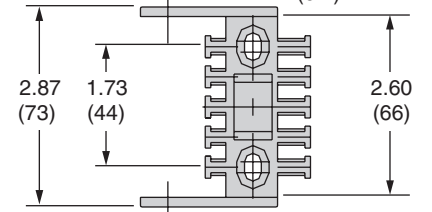

0450.61
PN: 52340

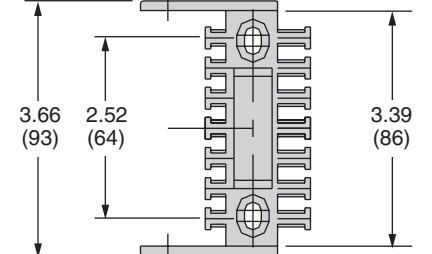

0450.81
PN: 52342

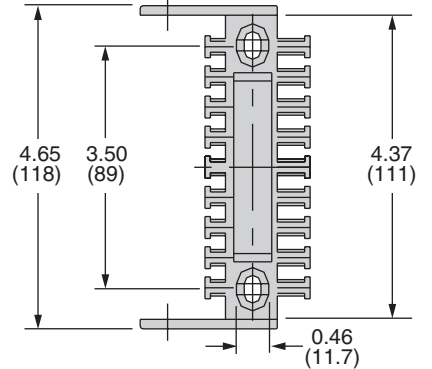

Fixed End Bracket



Moving End Bracket



Specifications are subject to change without notice.
KS-1106-GC-A

GENERAL DATA

E	CONOMIC
V	ALUE
A	DDED
3	
<p>A product group's EVA score is a general indicator that allows a customer to quickly and easily compare a product group's basic price, features, capabilities and value relative to other comparably sized products within the KS product range.</p>	
<p>Download 3D CAD files, videos, updated product info & much more at: www.kabelschlepp.com/plastitrak.htm</p>	

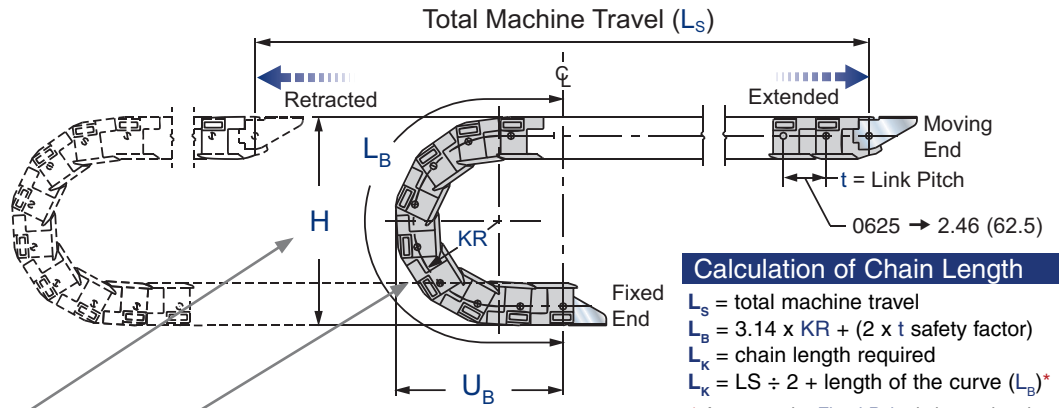

Calculation of Chain Length

L_s = total machine travel
 $L_b = 3.14 \times KR + (2 \times t \text{ safety factor})$
 L_k = chain length required
 $L_k = L_s \div 2 + \text{length of the curve } (L_b)^*$
 * Assumes the Fixed Point is located at the Center of the Total Machine Travel.

Dimensions in inches (mm)

Technical Data

Series
0625

Series	Mounting Height H	Bend Radius KR	Depot U_B	Loop Length L_B
Option A <i>special order</i>	8.11 (206)	2.95 (75)	6.50 (165)	14.21 (361)
Option B	9.29 (236)	3.54 (90)	7.09 (180)	16.06 (408)
Option C	12.05 (306)	4.92 (125)	8.46 (215)	20.39 (518)
Option D <i>special order</i>	14.02 (356)	5.91 (150)	9.45 (240)	23.46 (596)
Option E	17.95 (456)	7.87 (200)	11.42 (290)	29.69 (754)
Option F <i>special order</i>	21.89 (556)	9.84 (250)	13.39 (340)	35.83 (910)
Option G	25.83 (656)	11.81 (300)	15.35 (390)	42.05 (1068)

! * Bend Radii (KRs) 75, 150 and 250 are available via **special order**. Consult factory for details.

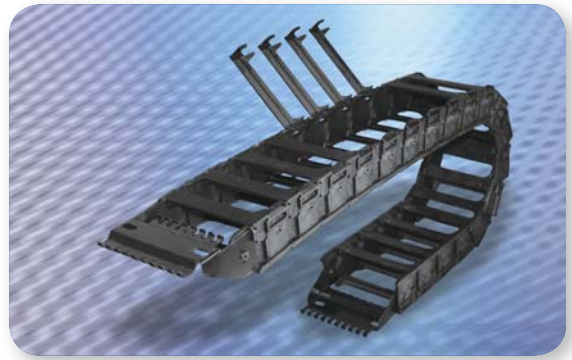

Self-Supporting Lengths

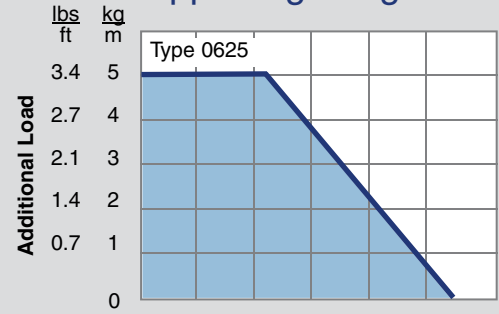

Unsupported Length 1.64 3.28 4.92 6.56 8.2 ft / 0.5 1.0 1.5 2.0 2.5 m

Extended Travel:

When application travel exceeds the self-supporting length of the carrier, PLASTITRAK carrier systems are designed to glide on themselves in a guide channel.



For more information on extended travel systems, see pages 2.27-2.36



$$\begin{array}{cccccccc}
 \text{Number of Systems Req.} & \times & \text{Carrier Type} & + & \text{Frame Stay Width} & + & \text{Bend Radius} & \times & \text{\# of Links Length} & + & \text{Type \& Position Brackets} & + & \text{Dividers (\#vert / \#horz)} \\
 \downarrow & & \downarrow & & \downarrow & & \downarrow & & \downarrow & & \downarrow & & \downarrow \\
 10 & \times & 0625 & \cdot & 65 & KR & 200 & \times & 42 \text{ Links} & + & FA/MA & + & 3v/1h
 \end{array}$$

Specifications are subject to change without notice. KS-1106-GC-A

Non-Opening - available widths

Series
0625

0625.22

Chain Weight:
1.02 lbs/ft
(1.55 kg/m)

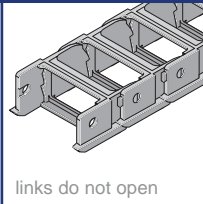
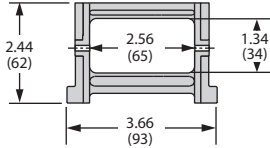

0625.42

Chain Weight:
1.14 lbs/ft
(1.70 kg/m)

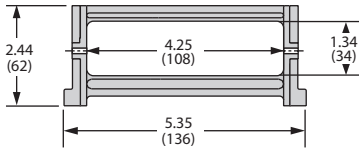

Snap-Open - available widths

Series
0625

0625.23

Chain Weight:
1.02 lbs/ft
(1.55 kg/m)

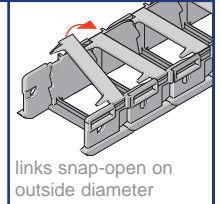
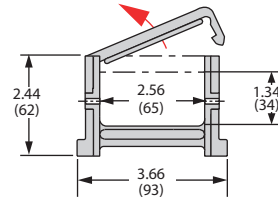

0625.25

Chain Weight:
1.17 lbs/ft
(1.74 kg/m)

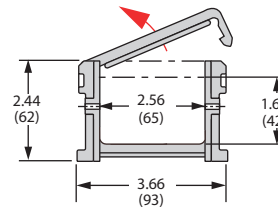

0625.43

Chain Weight:
1.19 lbs/ft
(1.70 kg/m)

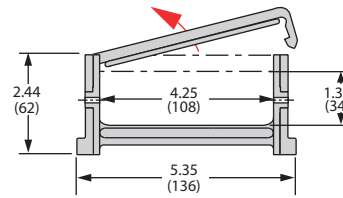

0625.45

Chain Weight:
1.38 lbs/ft
(2.06 kg/m)

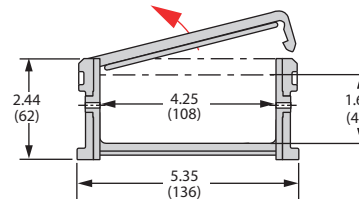

0625.55

Chain Weight:
1.39 lbs/ft
(2.07 kg/m)

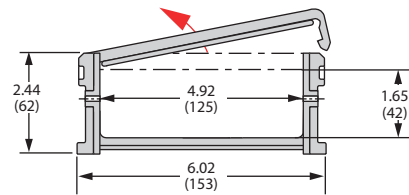

0625.65

Chain Weight:
1.44 lbs/ft
(2.15 kg/m)

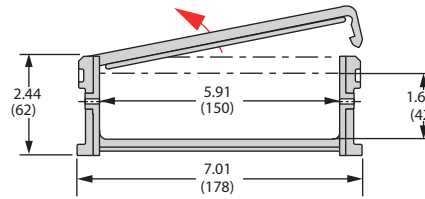

0625.75

Chain Weight:
1.59 lbs/ft
(2.37 kg/m)

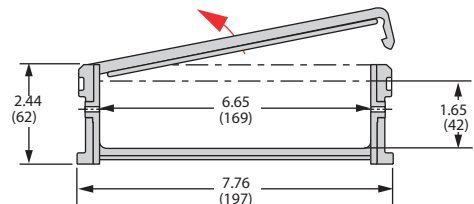

Optional Dividers

For 0625.22/.23/.42/.43 style carriers.

PN: 57781

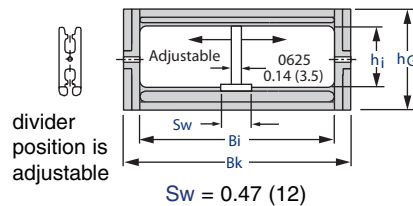

divider position is adjustable

Optional Dividers

For 0625.25/.45/.55/.65/.75 style carriers.

PN: 57784 (standard)
(4 mm thick)

PN: 57783 (for horz. shelving)
(6 mm thick)

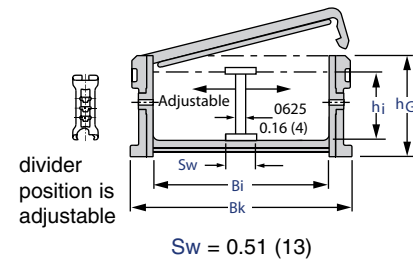

divider position is adjustable

Note:

For drawings and dimensions of available Mounting Bracket options see pages 6.16 - 6.17.





Series
0625 Strain Relief Mounting Brackets

Integral Strain Relief Metal Mounting Brackets for Plastitrak Series 0625

Fixed End Bracket - with pin

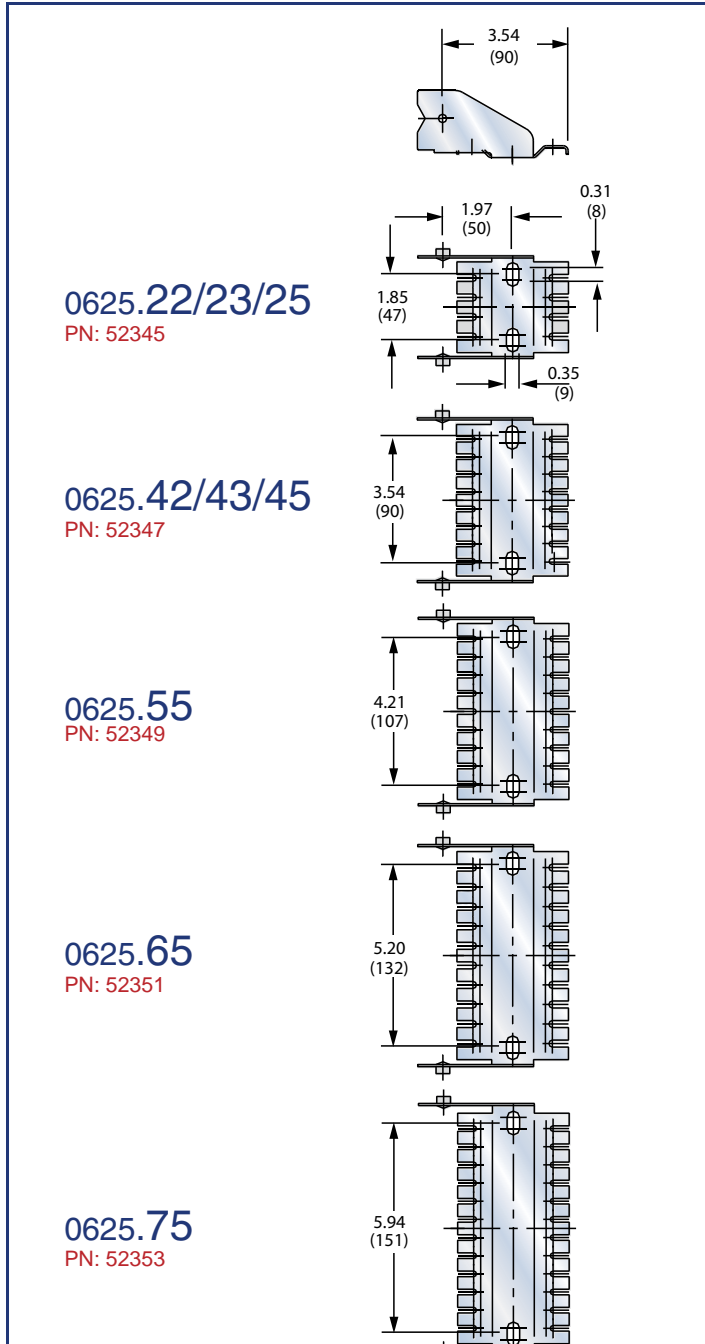

Moving End Bracket - with hole

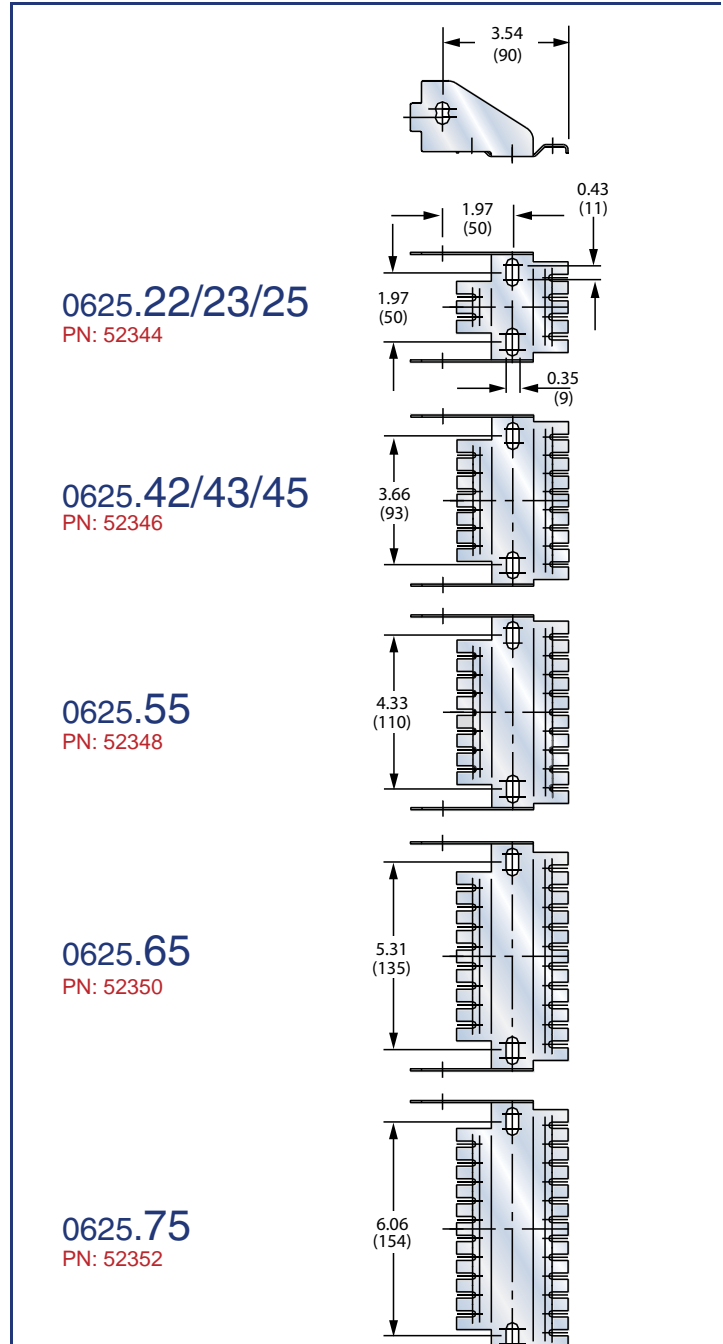

6 PLASTITRAK

0625.22/23/25

PN: 52345

0625.42/43/45

PN: 52347

0625.55

PN: 52349

0625.65

PN: 52351

0625.75

PN: 52353

0625.22/23/25

PN: 52344

0625.42/43/45

PN: 52346

0625.55

PN: 52348

0625.65

PN: 52350

0625.75

PN: 52352

Fixed End Bracket

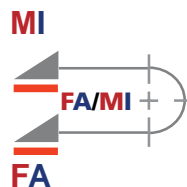
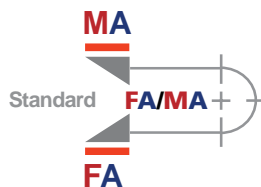

- M** = Moving End
- F** = Fixed End
- A** = O.D. Mount
- I** = I.D. Mount
- = Mounting Surface

Moving End Bracket



Specifications are subject to change without notice.
 KS-1106-GC-A

Series
0625 Standard Mounting Brackets (without strain relief)

Standard 4 Piece Metal Mounting Brackets for Plastittrak Series 0625

Fixed End Bracket - with pin

Note: brackets can be positioned with feet facing inward or outward

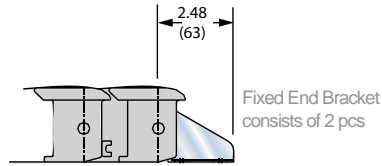

0625.22/23/25

PNs: 57772
57773

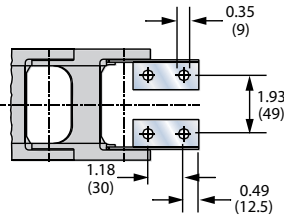

0625.42/43/45

PNs: 57772
57773

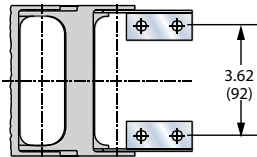

0625.55

PNs: 57772
57773

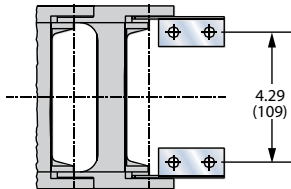

0625.65

PNs: 57772
57773

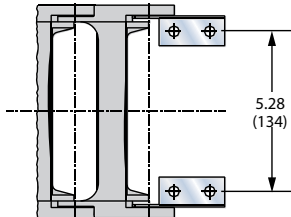

0625.75

PNs: 57772
57773

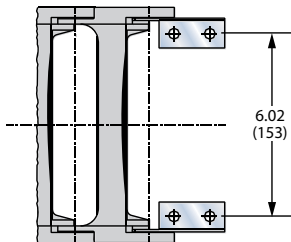

Moving End Bracket - with hole

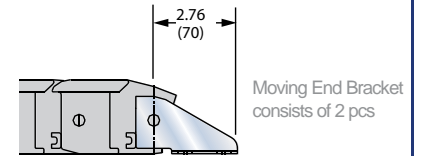

0625.22/23/25

PNs: 57770
57771

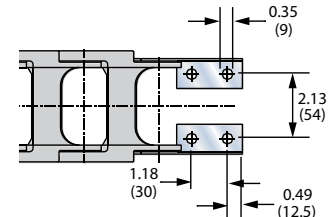

0625.42/43/45

PNs: 57770
57771

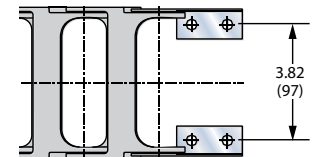

0625.55

PNs: 57770
57771

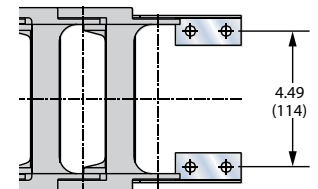

0625.65

PNs: 57770
57771

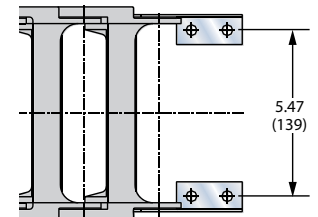

0625.75

PNs: 57770
57771

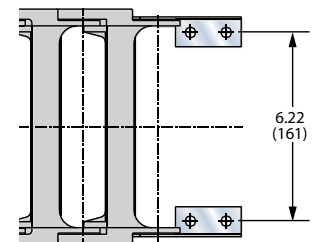

Fixed End Bracket



- M** = Moving End
- F** = Fixed End
- A** = O.D. Mount
- I** = I.D. Mount
- = Mounting Surface

Moving End Bracket



Specifications are subject to change without notice.
KS-1106-GC-A